

Capacity / Centre of gravity:
10,000 kg - 12,000 kg - 14,000 kg / 600 mm

Voltage: 120 V

Raised Operator Seat for maximum visibility even
with very bulky loads

Compact size

High performances

Long operating time

SERIES



Z 100 HD
Z 120 HD
Z 140 HD

GENERAL FEATURES

- Capacity / Centre of gravity:
10.000 - 12.000 - 14.000 kg / 600 mm
- Voltage: 120 V
- Tyres: Twin Superelastic
- Motors: AC
- Brakes: oil immersed
- Automatic Parking Brake
- Travel speed: 13 km/h
- Lifting speed: 0.36 m/s
- Battery 120 V – Maximum capacity 1656 Ah
- Advanced Multifunction Display (AMD)
- Reversing Camera
- High tilt cylinders
- Battery divided in two trays, easily-Removable battery

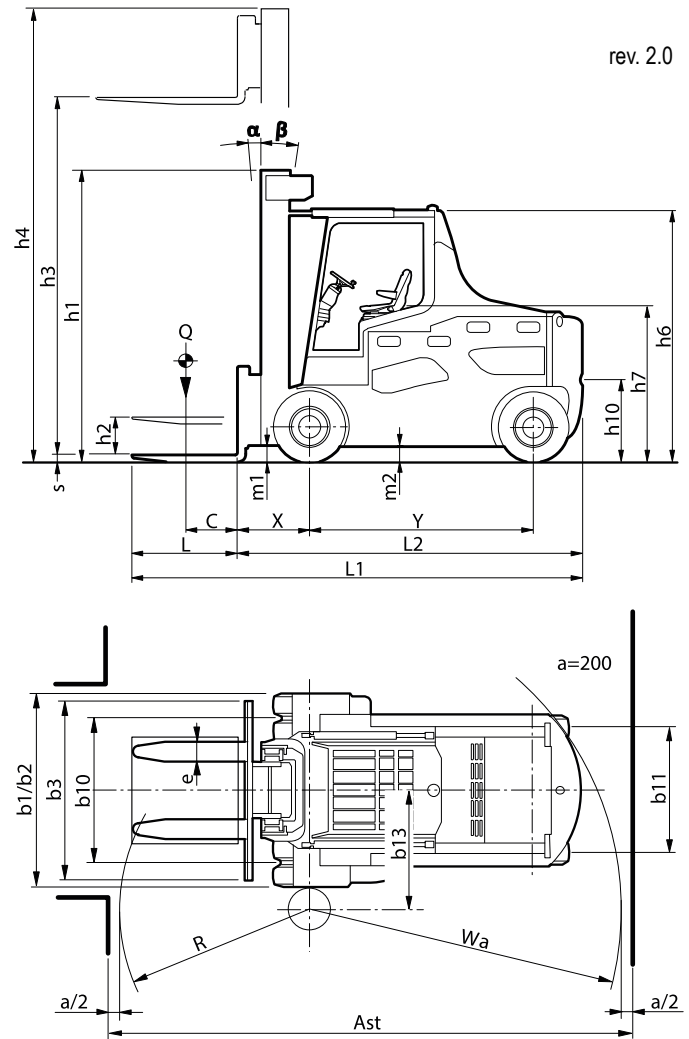

THE BENEFITS OF CHOOSING CARER



The newly-designed electric forklift trucks are developed at a voltage of 120 V to provide maximum efficiency and long operating time.

The Z100-140 HD is the ideal forklift truck to handle heavy loads with top safety and reliability.

Technical Features

The 120 V technology and development of the machine based on the concepts of power and efficiency offer high performance and long operating time.

The power of the motor, which is managed electronically, gives these forklift trucks unmatched acceleration, speed and



maneuverability.

The electronic control alternating current ensures the maximum silence and maximum engine efficiency.

The electric motors are developed and designed to withstand heavy-duty use.

Utmost Operator Comfort

The cabin, which is separated from the frame, provides extremely high operator comfort.

Mounted on a silent-block system, it minimizes vibrations and noise. All the surrounding area is clearly visible from the driver's seat and you can easily perceive the overall



dimensions of the forklift truck, even handling bulky loads ensuring the maximum vehicle's safety level.

The high tilt cylinders ensure excellent stability of the upright, thereby reducing torsions thanks to their position and the long lever arms.

The special frame structure is able to house large capacities 120 V batteries. The battery is divided into two to facilitate easy, safe and fast lateral removal.

		C.A.R.E.R. Srl					
IDENTIFICATION	1.1	Manufacturer					
	1.2	Manufacturer's type designation		Z 100 HD	Z 120 HD	Z 140 HD	
	1.3	Drive		electric	electric	electric	
	1.4	Operator type		seat	seat	seat	
	1.5	Load capacity/rated load	Q (t)	10	12	14	
	1.6	Load centre distance	C (mm)	600	600	600	
	1.8	Load distance	X (mm)	815 ^{(1) (2)}	815 ^{(1) (2)}	815 ^{(1) (2)}	
	1.9	Wheelbase	Y (mm)	2550	2550	2650	
WEIGHTS	2.1	Weight	(kg)	17400	19400	20400	
	2.2	Axle loading, laden front / rear	(kg)	24100 / 3300	28800 / 2600	31300 / 3100	
	2.3	Axle loading, unladen front / rear	(kg)	8550 / 8850	10140 / 9260	9820 / 10580	
WHEELS	3.1	Tyres type		C-SEG	C-SEG	C-SEG	
	3.2	Tyre size, front		854x(320+320) 300-15	854x(320+320) 355/50-20	854x(320+320) 355/50-20	
	3.3	Tyre size, rear		854x320 300-15	854x320 300-15	355/50-20	
	3.5	Wheels, number front rear (x = driven wheels)		4X / 2	4X / 2	4X / 2	
	3.6	Track width, front	b10 (mm)	1692 1645	1795 1795	1795	
	3.7	Track width, rear	b11 (mm)	1450 1450	1450 1450	1472	
	DIMENSIONS	4.1	Tilt of mast / fork carriage forward / backward		α/β (°)	7 / 8 ⁽²⁾	7 / 8 ⁽²⁾
4.2		Closed mast height		h1 (mm)	3050	2950	2950
4.3		Free lift		h2 (mm)	0	0	0
4.4		Lift (standard mast)		h3 (mm)	3400	3400	3400
4.5		Height, mast extended		h4 (mm)	4850	4850	4850
4.7		Height of overhead guard		h6 (mm)	2850	2850	2850
4.8		Seat height		h7 (mm)	1790	1790	1790
4.12		Coupling height		h10 (mm)	910	910	910
4.19		Overall length		L1 (mm)	5115	5115	5265
4.20		Length to face of forks		L2 (mm)	3915	3915	4065
4.21		Overall width		b1/b2 (mm)	2350 2200	2350 2350	2350 2350
4.22		Fork dimensions		ExSxL (mm)	200x60x1200	200x70x1200	200x70x1200
4.23		Fork carriage iso 2328/30, FEM/A,B			5A	CARER	CARER
4.24		Fork-carriage width		b3 (mm)	2000	2000	2000
4.31		Ground clearance, laden, below mast		m1 (mm)	180	180	180
4.32		Ground clearance, centre of wheelbase		m2 (mm)	130	130	130
4.33		Aisle width for pallets 1000x1200 crossways		Ast (mm)	5620	5670	5850
4.34	Aisle width for pallets 800x1200 lengthways		Ast (mm)	5820	5870	6050	
4.35	Turning radius		Wa (mm)	3600	3650	3800	
4.36	Internal turning radius		b13 (mm)	1450	1515	1650	
PERFORMANCE	5.1	Travel speed, laden / unladen		(km/h)	12.5 / 13	11 / 11.5	10 / 10.5
	5.2	Lift speed, laden / unladen		(m/s)	0.25 / 0.36	0.21 / 0.36	0.21 / 0.36
	5.3	Lowering speed, laden / unladen		(m/s)	0.5 / 0.4	0.5 / 0.4	0.5 / 0.4
	5.5	Drawbar pull, laden / unladen (S2 60')		(S2 60')	11000 / 12000	14000 / 15000	13000 / 15000
	5.6	Max. drawbar pull, laden / unladen (S2 5')		(N)	30000 / 31000	36000 / 38000	36000 / 38000
	5.7	Gradeability, laden / unladen (S2 30')		(%)	9 / 15	9 / 16	8 / 15
	5.8	Max. gradeability, laden / unladen (S2 5')		(%)	11 / 18	11 / 20	10 / 18
	5.9	Acceleration time, laden / unladen (10 m)		(s)	7 / 6,2	7 / 6,2	8 / 7
	5.10	Service brake: mech./hydr./electr.			hydraulic / electric	hydraulic / electric	hydraulic / electric
	MOTOR / BATT	6.1	Drive motor rating (S2 60')		(kW)	35	35
6.2		Lift motor rating (S3 20%)		(kW)	45	45	45
6.4		Battery voltage		U (V)	120	120	120
6.4.1		Rated capacity		K5 (Ah)	1260 / 1380 / 1500 / 1656 (IRONCLAD)	1380 / 1500 / 1656 (IRONCLAD)	1380 / 1500 / 1656 (IRONCLAD)
6.5		Battery weight minimum/maximum		(kg)	5000 / 5650	5400 / 5650	5400 / 5650
OTHERS	8.1	Type of drive control			inverter	inverter	inverter
	8.2	Operating pressure for attachments		(bar)	200	200	200
	8.4	Sound level at the driver's ear		(dBA)	-	-	-



C.A.R.E.R. Srl
via Copernico 13
48033 Cotignola (RA) Italy
phone +39 0545 1938010
fax +39 0545 908070
www.carerforklift.com
info@carerforklift.com

follow us on 